

FLAT LAYOUT

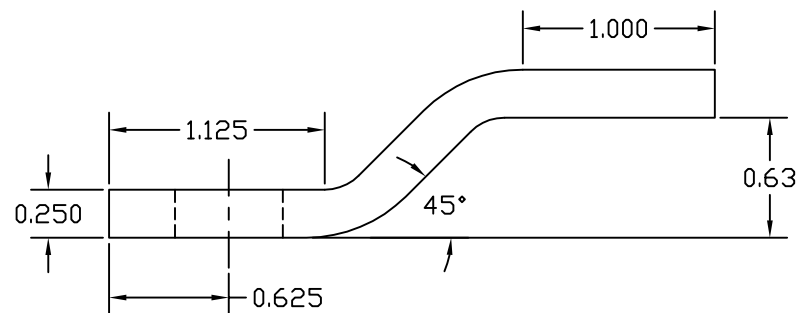

TINNED 1/4 X 1" OFFSET 1-HOLE LUG

EST WT .25#

APPROVED

☐ AS DRAWN: _____
☐ AS NOTED: _____
 DATE: _____

THIS DOCUMENT AND THE CONTENTS THEREOF IS THE PROPERTY OF HARGER INC., AND IS FURNISHED TO YOU FOR INFORMATION ONLY. THE INFORMATION CONTAINED HEREIN IS CONFIDENTIAL AND OF A PROPRIETARY NATURE AND MUST NOT BE DISCLOSED TO THIRD PARTIES WITHOUT THE EXPRESS WRITTEN APPROVAL OF HARGER INC.

B	CUT LN WAS 3.232 & REDRAW	051623	GTE
A	CUT LENGTH WAS 3.962	100302	EHS
LET	REVISION	DATE	BY
TOLERANCES UNLESS NOTED:			
FRACTIONAL +/- 1/16			
.00 +/- .03			
.000 +/- .010			
3RD ANGLE PROJECTION			

PART NO. OXL141
 OFFSET WELD LUG

DRAWN BY:
 EHS
 CHECKED BY:
 DATE:
 110501

HARGER

301 ZIEGLER DRIVE
 GRAYSLAKE, IL 60030
 (847) 548-8700

REVISION:
 B
 SCALE:
 FULL
 SHEET:
 1 OF 1